



 **ARISTON**

ELECTRIC WATER HEATERS

WATER HEATERS | GAS BOILERS | SOLAR SYSTEMS | HEAT PUMPS

80 YEARS OF GROWTH DRIVEN BY INNOVATION

Bringing the maximum comfort into the homes of our customers has been Ariston's priority for over 50 years.

Ariston products are manufactured in several plants in Italy: the first one was opened in 1960 and is still the center of Ariston's production. In 2012 Ariston manufactured more than 5.500.000 electric water heaters.

To guarantee to its customer a long-lasting comfort, all products are manufactured following the highest quality standards, according to the globally recognized ISO 9001.

/ TODAY

Ariston is a worldwide leading brand in thermic comfort present in over 150 countries.

/ 1960s-1980s

Ariston brand is launched and the production of electric water heaters begins. During 80s, Ariston has consolidated its market leadership in water heating and the production of boilers begins.

/ 1930s

Aristide Merloni founds "Industrie Merloni" company in the Marche Region of Italy, and starts the production of weighing scales.

ARISTON QUALITY: SIMPLY “MADE IN ITALY”

INTERNATIONAL QUALITY CERTIFICATION

All Ariston factories are certified by CSQ, a member of the International Certification Network IQNet.

As a result, all Ariston products are manufactured in compliance with the highest standards, guaranteeing reliability and high-quality.

Every year all the plants are involved in a competition aimed to improve the quality level of the production.



3 MILESTONES OF QUALITY

Customer satisfaction is Ariston's main concern and this is why quality is constantly monitored at every level through:

- **Incoming control** of the raw materials and components
- **Process Control** aiming to intercept the potential defects in earlier stages of the manufacturing process
- **Product Testing** of 100% of the production in the line to assure the correct functioning of the product



ITALIAN TECHNOLOGY & DESIGN

Driven by innovation but still linked to its roots.

This is the perfect mix that represent Ariston attitude and that pushes the members of the R&D department to develop more efficient, eco-friendly and reliable products always with the quality and design typical of the Italian manufacturing tradition.



WIDE RANGE, ABSOLUTE COMFORT

Ariston offers a wide range of products to cover every need, from the small houses to the big industrial applications, thus being the ideal partner for both end users and professionals. Starting from 10 lt up to 5000 lt, the product range offers an incredible variety of features and functionalities that guarantee long-lasting reliability, high performances, maximum comfort and easiness of use for the end user.

Find out more about the range and specific products at:
www.ariston.com



Small in capacity
Big in comfort

NEW



The perfect product
for everyday use

RANGE	SMALL	MEDIUM
CAPACITY [lt]	10-15-30	50-80-100
INSTALLATION	Over/under sink	Wall Hung
ORIENTATION	Vertical/horizontal	Vertical/horizontal
VOLTAGE [V]	230	230
POWER [kW]	1,2-1,5	0,8 - 1,2 - 1,5 - 1,8 - 2 -3
REGULATION	Mechanical	Electronic/Mechanical
HEATING ELEMENT	Copper	Copper
INLET/OUTLET CONNECTION	G 1/2"	G 1/2"
FLANGE TYPE	Autoclavic	5 bolts / autoclavic
TANK	Titanium enamelling	Titanium enamelling
	Polyurethane insulation	Polyurethane insulation
	Oversized Anode	Oversized Anode
MAIN FEATURES	Thermostat with bipolar safety device	Thermostat with bipolar safety device
	External Temperature regulation	External Temperature regulation
		Nanomix

NEW



All the hot water your need
right at the tap

NEW

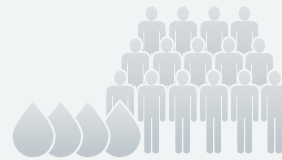

The ideal solution
for high demand of hot water

BIG

150-200-250-300-500

Wall Hung/Floor Standing

Vertical/horizontal

230/400

1,8 - 2,0 - 2,2 - 2,4 - 3,0 - 4,5 - 6,0

Mechanical

Copper

G 3/4"

6 bolts flange

Titanium enamelling

Polyurethane insulation

Oversized Anode

Thermostat with bipolar safety device

Inspection Flange

CALORIFIERS

500-750-1000-1500-2000-2500-3000-5000

Floor Standing (modular installation allowed)

Vertical

400

12 - 18 - 24 - 36 - 48 - 60 - 72 - 96

Mechanical

Incoloy stainless steel (low watt density)

G 2" - 3"

Flange plate connection

Tank enamelled a with special quartz coating "A class" quality, in accordance with DIN 51165 / ISO 2744

Floor Standing (modular installation allowed)

Double Thermostat (regulation between 30° C - 80° C, overheating at 95° C with manual reset)

Thermostat with bipolar safety device

Inspection Flange

Glass wool high heat insulation

EVERY DAY ONE SHOWER IS FREE

TRADITIONAL TECHNOLOGY

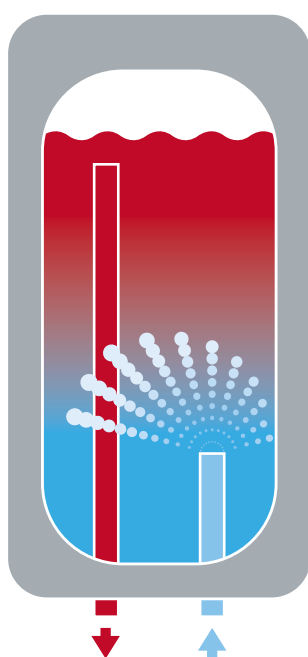

NANOMIX TECHNOLOGY

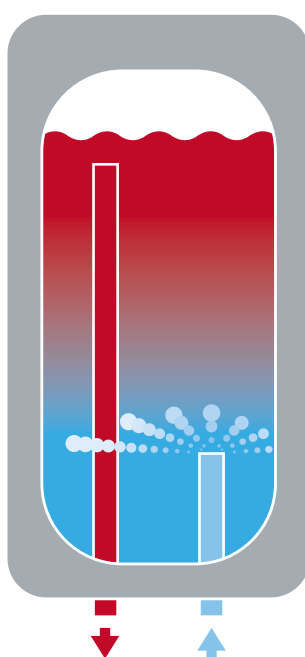

NANOMIX TECHNOLOGY

During the use, every withdrawal of hot water from the water heater is then balanced by cold water coming in. The Nanomix technology avoids that the water coming in makes the one inside cold. Thanks to a special deflector, Nanomix allows the water to mix more slowly, keeping in this way the internal temperature high and avoiding that the water heater turns on uselessly.

NANOMIX SYSTEM

The Nanomix system, with its new deflectors of water coming in, allows to produce up to 10% of hot water more than a traditional water heater with the same capacity. At the end of every heating cycle there will be up to 15 lt. more of water at 40°C. This water can be used by the users to improve their comfort.

15 lt
HOT WATER



BEST ELECTRONICS

The electronic microprocessor card works fast with the NTC probe to guarantee higher adjustment accuracy.

The thermostat is very sensitive and operates on the heating element with continuous diagnoses to face long demand of hot water.

Thanks to the high accuracy and reliability of the card, it is possible to heat the stored hot water up to 80°C.



NANOMIX+BEST SYSTEM

The Nanomix+Best solution combines performance benefits of Best electronic card with the new Nanomix technology. It allows to obtain higher performance up to 30% more than a traditional water heater with the same capacity. It means that, at the end of every heating cycle, the water heater will be able to provide the user with up to 40 lt. more of hot water at 40°C. This is the quantity of water used on average to have a shower in absolute comfort.

+1
SHOWER FREE
PER DAY



With the new Ariston water heaters it is possible to produce more hot water than with the traditional water heaters with the same capacity.

These higher performances allow both to turn the water heater on less frequently and to save money considerably on electricity bills.

The new Ariston products offer: more liters of hot water, higher performances, higher comfort and higher saving.

Furthermore, Best technology also helps to reduce energy consumption thanks to a continuous monitoring of the temperature, minimizing the heat dispersions.

higher
performance
and big
savings

HOW TO READ THE SYMBOLS

The icons have been designed to facilitate the reading of the features of each product. Ariston makes it possible, from the very beginning, to quickly and easily identify performance levels, understand the different ranges and evaluate purchasing criteria.

In short, users can familiarise themselves with each machine without becoming confused or wasting time, in line with the Ariston philosophy of always offering the customer - and the professional technician - a service which is clear and easy to use.



ECO
Reduction of consumption thanks to ECO function.



FLAT
Low depth which allows space saving and easy fitting.



LCD DISPLAY PROGRAMMER
Advanced LCD display with programmer to set easily your comfort.



INSPECTION FLANGE
Large inspection flange for a better and easier maintenance.



DISPLAY ECO
Frontal led control panel with smart thermometer.



ANTI-FREEZE
The water heater is protected against extremely low temperature.



SHOWER READY
shows when has been heated enough water for having the first shower.



MUTIPOSITION
The product can be installed in vertical or orizzontal position.



ABS
Total electronic safety package for a total safety comfort.



ELECTRONIC CONTROL
Electronic control panel for an easier use.



EXTERNAL TEMPERATURE REGULATION
Easy to set a temperature desired.



EMIRATES QUALITY MARK
Product certified by ESMA authority, complying with the strictest standards thus guaranteeing high performances and absolute safety.



NANOMIX + BEST
Much more quantity of hot water and top performance thanks to the BEST Technology and Nanomix.



CE
Product complying with European CE certification indicating high quality and absolute safety.



NANOMIX
More quantity of hot water thanks to special inlet pipe.



G-MARK
Conformity Marking for the GCC Countries



TITANIUM PLUS
A new technology which uses titanium enamelling for greater protection.

THE ADVANTAGES IN DETAIL

Extra thick insulation

There is a thick layer of high-density polyurethane foam which guarantees excellent insulation.

High-quality components

These are designed and manufactured by Ariston, where very strict checking methods are employed so as to ensure excellent operation, even after several years.

Environmentally-friendly technologies

Ariston is committed to conciliating industrial procedures with the respect of environmental balances.

The result of such a commitment is the elimination of chlorofluorocarbons (CFCs) from the insulation and the utmost care being taken in the selection of recyclable components.

Larger magnesium anode

This is particularly large in size and easy to inspect or replace, making the electrochemical protection of the tank all the more efficient.

IN THIS CATALOGUE

ELECTRIC WATER HEATERS MEDIUM CAPACITIES

- 12 / VELIS EVO PLUS
- 13 / VELIS EVO
- 15 / VELIS EVO LOW POWER
- 17 / PRO ECO
- 18 / PRO R
- 19 / BLU R

ELECTRIC WATER HEATERS SMALL CAPACITIES

- 22 / ANDRIS LUX ECO
- 23 / ANDRIS LUX
- 24 / ANDRIS RS
- 25 / BLU R

ELECTRIC WATER HEATERS BIG CAPACITIES

- 28 / ARI TOP
- 29 / ARI
- 30 / ARI STAB
- 32 / ACCESSORIES

ELECTRIC CALORIFIERS

- 35 / ES EXTRA 500 TO 5000
- 37 / CONTROL PANELS
- 38 / ES EXTRA 5000

The Internet site provides operators within the sector with all the information which are linked to the “product catalogue”, offering individual details of technical features, exploded views and spare parts lists, updates for operating booklets and instruction manuals. It provides users with telephone numbers and addresses for the relevant Assistance Centres and stockists in their local area.

ariston.com



 **ARISTON**

**ELECTRIC WATER HEATER
MEDIUM CAPACITY**

NEW VELIS EVO. THE SMART SIDE OF COMFORT.



MULTIPOSITION,
NEW VELIS EVO CAN BE
INSTALLED IN VERTICAL
OR HORIZONTAL POSITON

HEATING TIME

With its high-tech abilities, Velis Evo and Velis Evo Plus set a complete new standard of comfort. Thanks to their SMART DOUBLE TANK structure, they heat water more quickly so you can have a hot shower in 50 MINUTES*.

Ah, and they are also super-silent!



DESIGNED FOR A SMART FIT.

Smooth, soft lines to blend and fit the furniture of your bathroom.

Of course, this is Italian design.

Velis Evo and Velis Evo Plus are also available with different capacity levels for all needs.

SMART DISPLAY

With the SMART BLUE TECH touch screen display, you can now check how many showers are available and the waiting time for the next shower with Velis Evo Plus. You can also schedule two moments a day in which you want to have hot water ready for you.

SO SMART IT LEARNS FROM YOUR HABITS

Thanks to ECO EVO Powered by CoreTECH, Velis Evo and Velis Evo Plus remember when and how much hot water you use. Without no effort, you can have the hot water you need, when you need it.

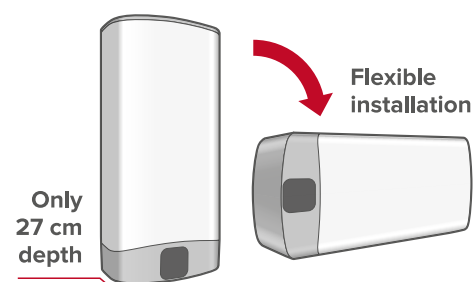
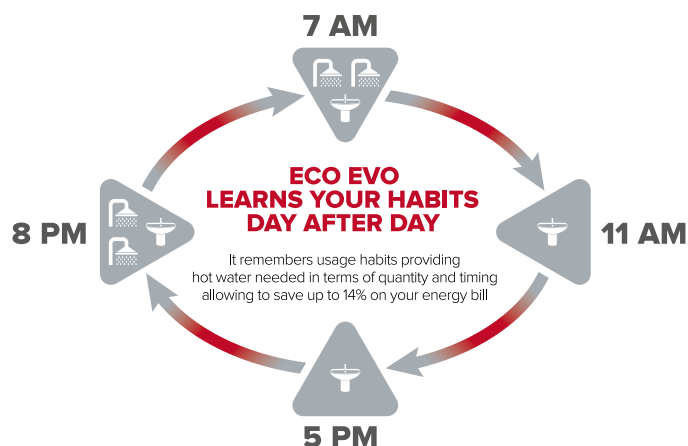

* Considering a shower like 48 lt at 40°C and inlet water temperature at 15°C

VELIS EVO PLUS

ECO EVO
FUNCTIONSAFETY
PACKAGEDISPLAY
SMARTSHOWER
READYTITANIUM
PLUSINCOLOY
ENAMELLED
HEATING ELEMENT

FLAT



MULTIPOSITION



COMFORT

- Double tank structure and smart quick heating function: shower ready in 50 minutes
- Smart touch screen Blue Tech display showing the number of showers available and waiting time for the next shower
- Smart Wi-Fi connection
- Super silent water heating

EFFICIENCY&ENERGY SAVING

- Eco Evo powered by CoreTECH
- Daily programming
- Ecological polyurethane insulation

QUALITY

- Everlasting anode
- ABS 2.0 safety system in case of energy or water failures
- Titanium enamelled double tank for a long durability

DESIGN

- Multiposition installation
- Only 27 cm deep
- Exclusive Italian design
- Silver metal finishing, to blend and fit the furniture of your bathroom

innovation and style



علامة الجودة الإماراتية
Emirates Quality Mark



TECHNICAL DATA

VLS EVO PLUS 50 VLS EVO PLUS 80 VLS EVO PLUS 100

Capacity	l	50	80	100
Installation		Multiposition (V/H)	Multiposition (V/H)	Multiposition (V/H)
Power	kW	1,5	1,5	1,5
Voltage	V	230	230	230
Heating time ($\Delta T=45^{\circ}\text{C}$)	h,min	1,30	2,15	2,50
Max working pressure	bar	8	8	8
Max working temperature	$^{\circ}\text{C}$	80	80	80
Weight	kg	21,7	28,3	32,2
Class	IP	IPX4	IPX4	IPX4

OVERALL DIMENSIONS

a	mm	776	1066	1251
b	mm	405	695	880

CODE

With Plug and Cable (PL)	3623262	3623263	3623264
--------------------------	---------	---------	---------

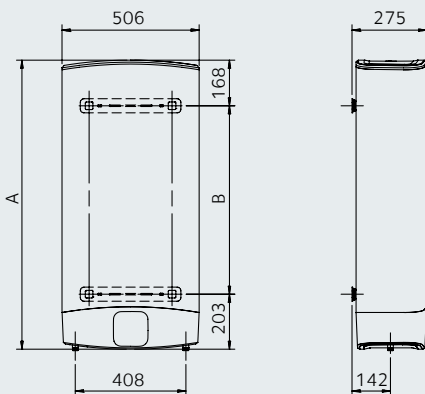

VELIS EVO

ECO EVO
FUNCTIONSAFETY
PACKAGEDISPLAY
SMARTSHOWER
READY

TITANIUM PLUS

INCOLOY
ENAMELLED
HEATING ELEMENT

FLAT



MULTIPOSITION



علامة الجودة الإماراتية
Emirates Quality Mark



COMFORT

- Double tank structure and smart quick heating function: shower ready in 50 minutes
- Smart display for easy temperature management with first shower availability alert
- Super silent water heating

EFFICIENCY&ENERGY SAVING

- Eco Evo powered by CoreTECH
- Daily programming
- Ecological polyurethane insulation

QUALITY

- Everlasting anode
- ABS 2.0 safety system in case of energy or water failures
- Titanium enamelled double tank for a long durability

DESIGN

- Multiposition installation
- Only 27 cm deep
- Exclusive Italian design
- White clean finishing, to blend and fit the furniture of your bathroom

design and substance

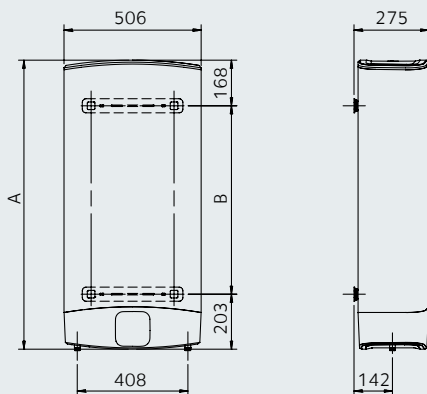

TECHNICAL DATA

		VLS EVO 50	VLS EVO 80	VLS EVO 100
Capacity	l	50	80	100
Installation		Multiposition (V/H)	Multiposition (V/H)	Multiposition (V/H)
Power	kW	1,5	1,5	1,5
Voltage	V	230	230	230
Heating time ($\Delta T=45^{\circ}\text{C}$)	h,min	1,30	2,15	2,50
Max working pressure	bar	8	8	8
Max working temperature	$^{\circ}\text{C}$	80	80	80
Weight	kg	21,7	28,3	32,2
Class	IP	IPX4	IPX4	IPX4

OVERALL DIMENSIONS

		VLS EVO 50	VLS EVO 80	VLS EVO 100
a	mm	776	1066	1251
b	mm	405	695	880

CODE

	VLS EVO 50	VLS EVO 80	VLS EVO 100
With Plug and Cable (PL)	3626093	3626094	3626095

NEW VELIS EVO LOW POWER. LESS POWER, SAME COMFORT.



EFFICIENCY & COMFORT

Thanks to their SMART DOUBLE TANK structure, they heat water more quickly compared with a traditional water heater with lower power.

MULTIPOSITION INSTALLATION

ECO EVO FUNCTION

Thanks to ECO EVO Powered by CoreTECH, Velis Evo remember when and how much hot water you use. Without no effort, you can have the hot water you need, when you need it saving up to 14% of energy consumption.

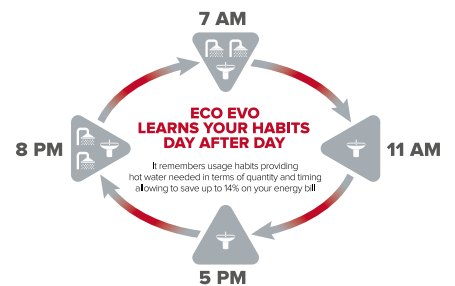

SAVE YOUR BUDGET!

With VELIS EVO LOW POWER you can save up to 47% of your power peak loading and 14% of electric consumption.

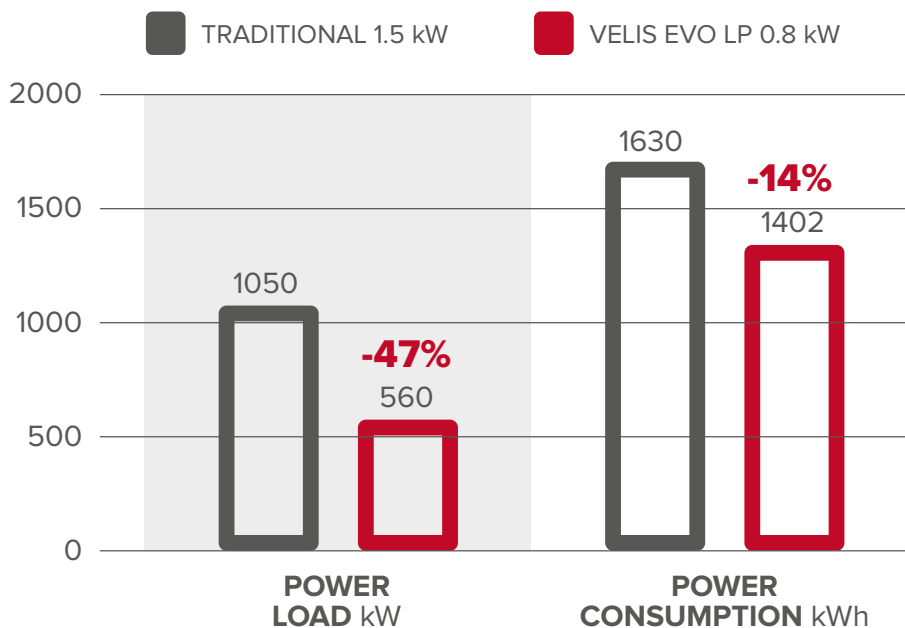

BUILDING 250 APARTMENTS



VELIS EVO LOW POWER

ECO EVO
FUNCTIONSAFETY
PACKAGEDISPLAY
SMARTSHOWER
READY

TITANIUM PLUS

INCOLOY
ENAMELLED
HEATING ELEMENT

FLAT



MULTIPOSITION



COMFORT

- Smart display for easy temperature management with first shower availability alert
- Super silent water heating

EFFICIENCY&ENERGY SAVING

- Low Power with only 0,8 kW heating element
- Eco Evo powered by CoreTECH
- Daily programming
- Ecological polyurethane insulation

QUALITY

- Everlasting anode
- ABS 2.0 safety system in case of energy or water failures
- Titanium enamelled double tank for a long durability

DESIGN

- Multiposition installation
- Only 27 cm deep
- Exclusive Italian design
- White clean finishing, to blend and fit the furniture of your bathroom

only 0,8kW
power



علامة الجودة الإماراتية
Emirates Quality Mark

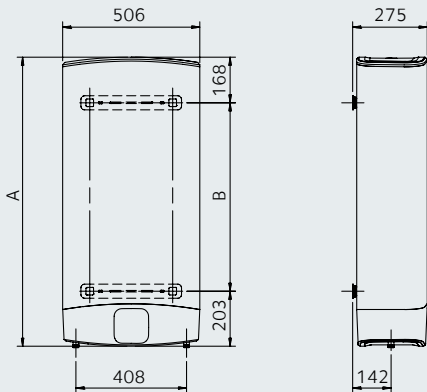

TECHNICAL DATA

VLS EVO LP 50 VLS EVO LP 80 VLS EVO LP 100

Capacity	l	50	80	100
Installation		Multiposition (V/H)	Multiposition (V/H)	Multiposition (V/H)
Power	kW	0,8	0,8	0,8
Voltage	V	230	230	230
Heating time ($\Delta T=45^{\circ}\text{C}$)	h,min	3,55	5,40	7,00
Max working pressure	bar	8	8	8
Max working temperature	$^{\circ}\text{C}$	80	80	80
Weight	kg	21,7	28,3	32,2
Class	IP	IPX4	IPX4	IPX4

OVERALL DIMENSIONS

a	mm	776	1066	1251
b	mm	405	695	880

PRO ECO FREEDOM TO SAVE WITH ABSOLUTE COMFORT.



PRO ECO is the best solution for the user who wants a product able to guarantee the maximum saving and at the same time maximum performance and maximum safety. Thanks to ECO technology, Nanomix+Best system and the ABS package, PRO ECO allows the user to save up to 10% energy consumption per year, to produce up to 40 lt. more of water at 40°C and to offer the maximum use safety.

There is a new design for PRO ECO: the Smart thermometer is in the frontal led control panel.

**Exclusive
design**

10%
ENERGY SAVING

PRO ECO

ECO
FUNCTIONSAFETY
PACKAGETITANIUM
PLUSDISPLAY
ECONANOMIX
+ BEST

COMFORT

- Digital temperature regulation
- High precision NTC temperature sensors

EFFICIENCY&ENERGY SAVING

- Eco function
- Ecological polyurethane insulation

QUALITY

- Titanium glasslined inner tank tested at 16 bar
- Oversize magnesium anode
- 5-bolts flange
- Pressure safety valve tested at 8 bar
- ABS safety package

DESIGN

- Led display
- Exclusive Italian design
- Wall-hung



علامة الجودة الإماراتية
Emirates Quality Mark



comfort
and saving

TECHNICAL DATA

		PRO ECO 50 V	PRO ECO 80 V	PRO ECO 100 V	PRO ECO 50 H	PRO ECO 80 H	PRO ECO 100 H
Capacity	l	50	80	100	50	80	100
Installation	V	V	V	V	H	H	H
Size		Regular	Regular	Regular	Regular	Regular	Regular
Power	kW	1,5	1,5	1,5	1,2	1,5	1,5
Voltage	V	230	230	230	230	230	230
Heating time ($\Delta T=45^{\circ}\text{C}$)	h,min	1:50'	2:56'	3:40'	2:17'	2:56'	3:40'
Heat dispersion at 65°C	kWh/24h	0,96	1,22	1,39	0,96	1,48	1,65
Max working pressure	bar	8	8	8	8	8	8
Max working temperature	$^{\circ}\text{C}$	80	80	80	80	80	80
Weight	kg	16,5	22	25,5	16,5	22	25,5
Class	IP	IPX3	IPX3	IPX3	IPX1	IPX1	IPX1

OVERALL DIMENSIONS

	mm	50	80	100	50 H	80 H	100 H
a	mm	550	758	913	550	758	913
b	mm	398	603	758	-	-	-
c	mm	-	-	-	155	174	177
d	mm	-	-	-	160	335	487

CODE

3200417	3200418	3200419	3200420	3200421	3200422
---------	---------	---------	---------	---------	---------

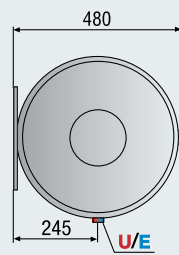
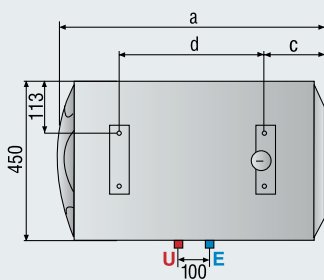
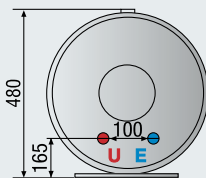
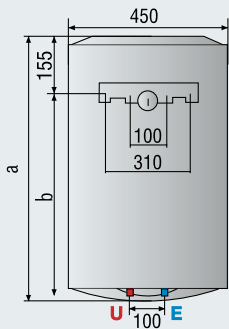

LEGEND

- E** Cold water inlet G 1/2"
- U** Hot water outlet G 1/2"

PRO R



NANOMIX

EXTERNAL
TEMPERATURE
REGULATION

COMFORT

- Temperature regulation

EFFICIENCY&ENERGY SAVING

- Ecological polyurethane insulation

QUALITY

- Glasslined inner tank tested at 16 bar
- Oversize magnesium anode
- 5-bolts flange
- Pressure safety valve tested at 8 bar

DESIGN

- Exclusive Italian design
- Wall-hung



علامة الجودة الإماراتية
Emirates Quality Mark



**ease
guaranteed**

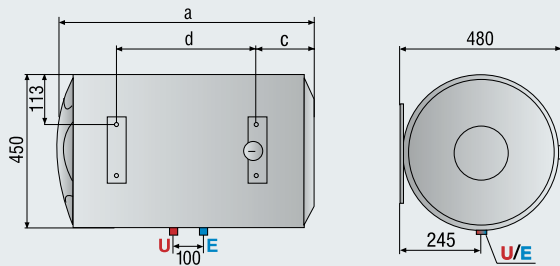
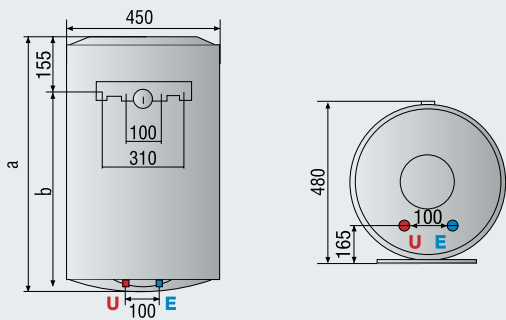

LEGEND

- E** Cold water inlet G 1/2"
- U** Hot water outlet G 1/2"

TECHNICAL DATA

		PRO R 50 V	PRO R 80 V	PRO R 100 V	PRO R 50 H	PRO R 80 H	PRO R 100 H
Capacity	l	50	80	100	50	80	100
Installation	V	V	V	V	H	H	H
Size		Regular	Regular	Regular	Regular	Regular	Regular
Power	kW	1,5	1,5	1,5	1,2	1,5	1,5
Voltage	V	230	230	230	230	230	230
Heating time ($\Delta T=45^{\circ}\text{C}$)	h,min	1:50'	2:56'	3:40'	2:17'	2:56'	3:40'
Heat dispersion at 65°C	kWh/24h	0,96	1,22	1,39	1,02	1,48	1,65
Max working pressure	bar	8	8	8	8	8	8
Max working temperature	$^{\circ}\text{C}$	75	75	75	75	75	75
Weight	kg	16,5	22	25,5	16,5	22	25,5
Class	IP	IPX3	IPX3	IPX3	IPX1	IPX1	IPX1

OVERALL DIMENSIONS

	mm	50	80	100	50 H	80 H	100 H
a	mm	550	758	913	550	758	913
b	mm	398	603	758	-	-	-
c	mm	-	-	-	155	174	177
d	mm	-	-	-	160	335	487

CODE

50	80	100	50 H	80 H	100 H
3200423	3200424	3200425	3200426	3200427	3200428

BLU R



COMFORT

- External temperature regulation

EFFICIENCY&ENERGY SAVING

- Extra thick polyurethane insulation

QUALITY

- High thickness steel tank tested at 16 atm
- Oversized magnesium anode
- Original Ariston thermostat with built-in safety device
- External thermometer
- Pressure safety valve rated at 8 bar

DESIGN

- Wall-hung



علامة الجودة الإماراتية
Emirates Quality Mark



good
looking

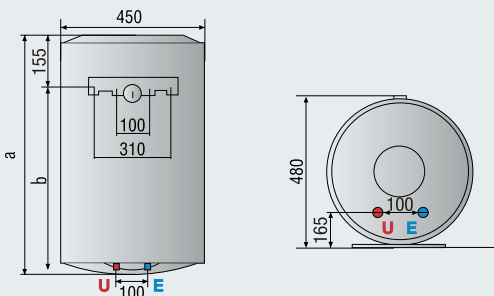

TECHNICAL DATA

		BLU R 50 V	BLU R 80 V	BLU R 100 V	BLU R 50 H	BLU R 80 H	BLU R 100 H
Capacity	l	50	80	100	50	80	100
Power	kW	1,5	1,5	1,5	1,2	1,5	1,5
Voltage	V	230	230	230	230	230	230
Heating time (T= 45°C) h,	min.	1,50	2,56	3,40	2,17	2,56	3,40
Max. Working Temp.	°C	75	75	75	75	75	75
Heat dispersion	kWh/24h	0,96	1,22	1,39	1,02	1,48	1,65
Max. Working Pressure	bar	8	8	8	8	8	8
Weight	kg	17	23	25	17	23	25
Protection	IP	IPX3	IPX3	IPX3	IPX1	IPX1	IPX1

OVERALL DIMENSIONS

		mm	mm	mm	mm	mm	mm
a	mm	550	758	913	550	758	913
b	mm	398	603	758	-	-	-
c	mm	-	-	-	155	174	177
d	mm	-	-	-	160	335	487

CODE

3605199 3605200 3605201 3605202 3605203 3605204

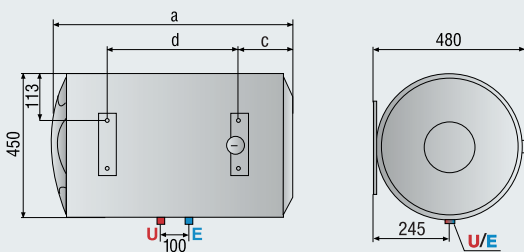

LEGEND

- E** Cold water inlet G 1/2"
- U** Hot water outlet G 1/2"



ELECTRIC WATER HEATERS SMALL CAPACITY

COMPACT SIZE, HIGH PERFORMANCE



The high quality performance of Ariston water heaters is now available in a compact solution.

/ SMALL SIZE

Thanks to the Mini-Tank System, the comfort of Ariston water heating is concentrated in a compact solution. Nevertheless their small size, the three products are able to heat up to 30 liters of water.

/ DURABILITY

The selection of materials is the secret behind the durability of Andris series products: they all have the heating element made of copper for an anti-corrosion effect.

The stronger structure of the flange limits the risk of leaking and reduces maintenance needs in time.

/ MAXIMUM COMFORT

Andris storage water heaters can keep water hot for a long period of time due to a high-density and thick polyurethane insulation between the tank and the external of the water heater.

It is an effective barrier against heat loss, optimizing the water heater's performance and your comfort.

/ DESIGN

Andris series products have been designed with the elegance and style that make Ariston products stand out, thanks to the continuous collaboration with Italian designers.

/ TOTAL SAFETY AND HYGIENE

Andris series have passed all the safety tests required to be fully compliant with CE directives.

The heating element in copper helps increasing the hygiene and purity of the water warmed by the water heater.

ANDRIS LUX ECO



COMFORT

- Electronic thermostat
- Temperature LED Display
- Digital temperature setting

EFFICIENCY&ENERGY SAVING

- ECO EVO function
- Ecological polyurethane insulation

QUALITY

- ABS safety package
- Titanium glasslined inner tank tested at 16 bar
- Oversized magnesium anode
- Pressure safety valve tested at 8 bar
- Copper heating element
- 4 bolts flange

DESIGN

- Led Display
- Premium Italian design

design with maximum comfort



علامة الجودة الإماراتية
Emirates Quality Mark



TECHNICAL DATA

ANDRIS LUX ECO 10 ANDRIS LUX ECO 10U ANDRIS LUX ECO 15 ANDRIS LUX ECO 15U ANDRIS LUX ECO 30

Capacity	l	10	10	15	15	30
Installation		Oversink	Undersink	Oversink	Undersink	Oversink
Power	kW	1,2	1,2	1,2	1,2	1,5
Voltage	V	220	220	220	220	220
Heating time (ΔT=45°C)	h,min	0,29	0,29	0,44	0,44	1,1
Heat dispersion at 65°C	kWh/24h	0,43	0,55	0,53	0,65	0,61
Max working pressure	bar	8	8	8	8	8
Max working temperature	°C	80	80	80	80	80
Weight	kg	6,6	6,6	7,4	7,4	12,8
Protection	IP	IPX4	IPX4	IPX4	IPX4	IPX4

OVERALL DIMENSIONS

a	mm	360	360	360	360	446
b	mm	294	294	342	342	406
c	mm	144	144	144	144	165
d	mm	92	92	78	78	115

CODE

3100345 3100346 3100349 3100350 3100353

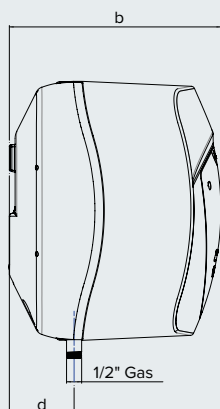
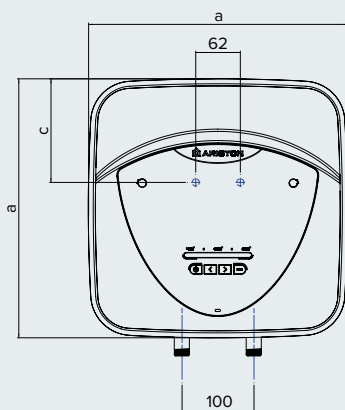

ANDRIS LUX



COMFORT

- Temperature regulation
- Reduced restore time

EFFICIENCY&ENERGY SAVING

- Ecological polyurethane insulation

QUALITY

- Titanium glasslined inner tank tested at 16 bar
- Oversized magnesium anode
- Pressure safety valve tested at 8 bar
- Copper heating element
- 4 bolts flange

DESIGN

- Elegant aesthetic

design and substance



علامة الجودة الإماراتية
Emirates Quality Mark

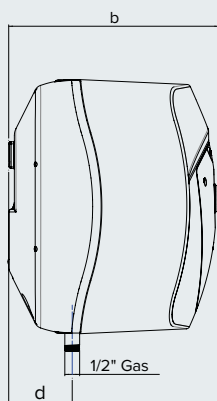
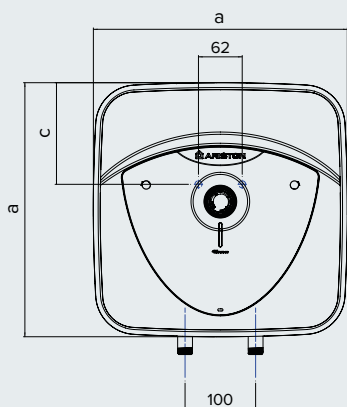

TECHNICAL DATA

		ANDRIS LUX 10	ANDRIS LUX 10 U	ANDRIS LUX 15	ANDRIS LUX 15 U	ANDRIS LUX 30
Capacity	l	10	10	15	15	30
Installation		Oversink	Undersink	Oversink	Undersink	Oversink
Power	kW	1,2	1,2	1,2	1,2	1,5
Voltage	V	220	220	220	220	220
Heating time ($\Delta T=45^{\circ}C$)	h,min	0,29	0,29	0,44	0,44	1,1
Heat dispersion at $65^{\circ}C$	kWh/24h	0,43	0,55	0,53	0,65	0,61
Max working pressure	bar	8	8	8	8	8
Max working temperature	$^{\circ}C$	80	80	80	80	80
Weight	kg	6,6	6,6	7,4	7,4	12,8
Protection	IP	IPX5	IPX5	IPX5	IPX5	IPX5

OVERALL DIMENSIONS

		mm	mm	mm	mm	mm
a	mm	360	360	360	360	447
b	mm	298	298	346	346	410
c	mm	144	144	144	144	165
d	mm	92	92	78	78	114

CODE

3100641 3100642 3100643 3100650 3100644

ANDRIS RS



COMFORT

- Temperature regulation

EFFICIENCY&ENERGY SAVING

- Ecological polyurethane insulation

QUALITY

- Glasslined inner tank tested at 16 bar
- Oversized magnesium anode
- Pressure safety valve tested at 8 bar
- Copper heating element
- 4 bolts flange

DESIGN

- Modern aesthetic

everyday
comfort



علامة الجودة الإماراتية
Emirates Quality Mark

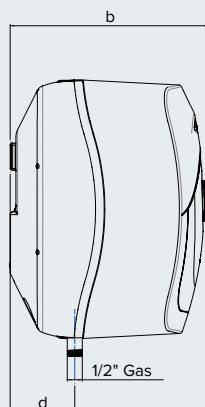
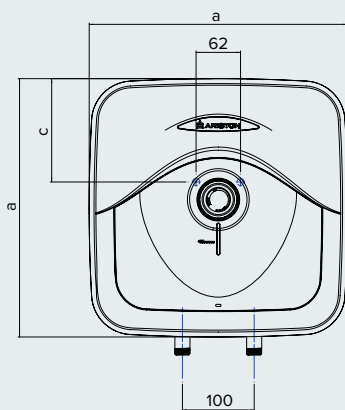

TECHNICAL DATA

		ANDRIS RS 10	ANDRIS RS 10U	ANDRIS RS 15	ANDRIS RS 15U	ANDRIS RS 30
Capacity	l	10	10	15	15	30
Installation		Oversink	Undersink	Oversink	Undersink	Oversink
Power	kW	1,2	1,2	1,2	1,2	1,5
Voltage	V	230	230	230	230	230
Heating time (ΔT=45°C)	h,min	0,29	0,29	0,44	0,44	1,1
Heat dispersion at 65°C	kWh/24h	0,43	0,55	0,53	0,65	0,61
Max working pressure	bar	8	8	8	8	8
Max working temperature	°C	80	80	80	80	80
Weight	kg	6,6	6,6	7,4	7,4	12,8
Protection	IP	IPX1	IPX1	IPX1	IPX1	IPX1

OVERALL DIMENSIONS

	mm	360	360	360	360	447
a	mm	298	298	346	346	410
b	mm	144	144	144	144	165
c	mm	92	92	78	78	114
d	mm					

CODE

3100631 3100632 3100633 3100634 3100635

BLU R



COMFORT

- External temperature regulation

EFFICIENCY&ENERGY SAVING

- Ecological thick polyurethane insulation
- High sensitivity thermostat

QUALITY

- High thickness steel tank tested at 16 atm
- Oversized magnesium anode
- Glasslined inner tank
- Pressure safety valve rated at 8 bar

DESIGN

- Wall-hung



علامة الجودة الإماراتية
Emirates Quality Mark



customizable
comfort

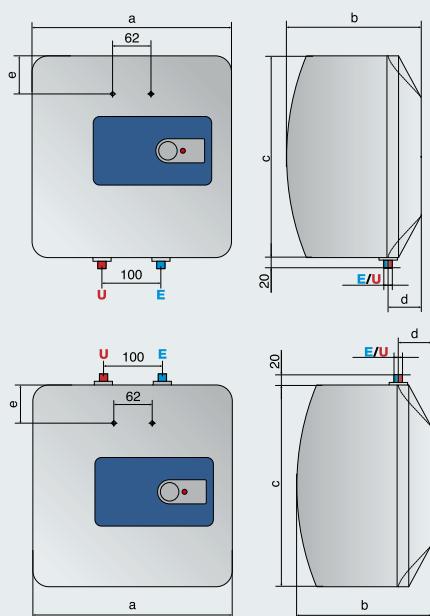

TECHNICAL DATA

		BLU R 10 OR	BLU R 10 UR	BLU R 15 OR	BLU R 15 UR	BLU R 30
Capacity	l	10	10	15	15	30
Power	kW	1,2	1,2	1,2	1,2	1,5
Voltage	V	230	230	230	230	230
Heating time (delta T=45°C)	h,min	0,29	0,29	0,44	0,44	1,10
Max heating temperature	°C	80	80	80	80	80
Heat dispersion	kWh/24h	0,43	0,55	0,53	0,65	0,61
Max working pressure	bar	8	8	8	8	8
Weight	kg	6,4	6,4	7,1	7,2	12
Protection	IP	IPX1	IPX1	IPX1	IPX1	IPX1

OR= oversink
UR= undersink

OVERALL DIMENSIONS

	mm	360	360	360	360	446
a	mm	360	360	360	360	446
b	mm	254	254	300	300	360
c	mm	360	360	360	360	446
d	mm	92	92	78	78	115
e	mm	144	144	144	144	165

CODE

3605462 3605463 3605464 3605465 3605466

LEGEND

- E** Cold water inlet G 1/2"
- U** Hot water outlet G 1/2"



**ELECTRIC WATER HEATERS
BIG CAPACITY**

ARI TOP THE BEST COMFORT WITH MAXIMUM SAFETY



/ QUICK HEATING

Thanks to the two heating elements of 4,5 kW in the bottom side and upper side of the tank, you can reduce the first shower timing and guarantee the best amount of hot water available.



/ MAXIMUM SAFETY

Thanks to the T&P valve and 10 bar pressure tank.



**Two by 4,5kW
heating elements**

ARI TOP



NEW



علامة الجودة الإماراتية
Emirates Quality Mark



COMFORT

- Quick heating thanks to the two heating element of 4,5 kW
- Temperature regulation

EFFICIENCY&ENERGY SAVING

- Ecological polyurethane insulation

QUALITY

- T&P safety valve
- 10 bar pressure safety valve
- Titanium glasslined inner tank tested at 16 bar
- Oversize magnesium anode
- 5-bolts flange

DESIGN

- Exclusive Italian design
- Floor Standing

two by 4,5kW heating element

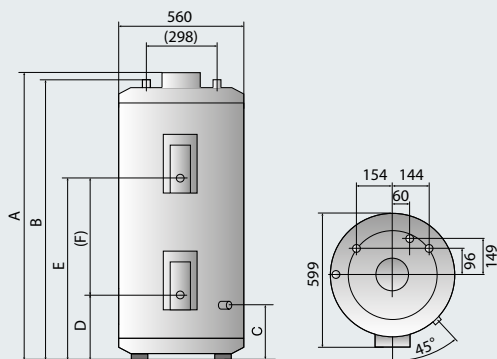

TECHNICAL DATA

		ARI TOP 160 240V MO	ARI TOP 200 240V MO	ARI TOP 300 240V MO	ARI TOP 300 415V TR
Capacity	l	160	200	300	300
Power	kW	4,5kW / 4,5 kW*	4,5kW / 4,5 kW*	4,5kW / 4,5 kW*	4,5 kW + 4,5 kW**
Voltage	V	240	240	240	415
Phase		Mono-phase	Mono-phase	Mono-phase	Tri-phase
Installation		Floor Standing	Floor Standing	Floor Standing	Floor Standing
Diameter	mm	560	560	560	560
Anode		Magnesium	Magnesium	Magnesium	Magnesium
Protection	IP	IPX1	IPX1	IPX1	IPX1
Inner tank		Enameled	Enameled	Enameled	Enameled
Working pressure	bar	10	10	10	10

OVERALL DIMENSIONS

		ARI TOP 160 240V MO	ARI TOP 200 240V MO	ARI TOP 300 240V MO	ARI TOP 300 415V TR
a	mm	1089	1331	1857	1857
b	mm	1058	1299	1825	1825
c	mm	238	250	254	254
d	mm	291	310	314	314
e	mm	651	822	1174	1174
f	mm	360	512	860	860

CODE

	ARI TOP 160 240V MO	ARI TOP 200 240V MO	ARI TOP 300 240V MO	ARI TOP 300 415V TR
	3060339	3060340	3060341	3060344

* The heating element will not work together, maximum absorption power of 4,5 kW.

** Heating elements will work simultaneously. Max absorption 9kW.

LEGEND

E Cold water inlet G 1"

U Hot water outlet G 1"

ARI

TITANIUM
PLUS
TITANIUM PLUS**COMFORT**

- Temperature regulation

EFFICIENCY&ENERGY SAVING

- Ecological polyurethane insulation

QUALITY

- Titanium glasslined inner tank tested at 16 bar
- Oversize magnesium anode
- 5-bolts flange
- Pressure safety valve tested at 8 bar

DESIGN

- Exclusive Italian design
- Wall-hung



علامة الجودة الإماراتية
Emirates Quality Mark

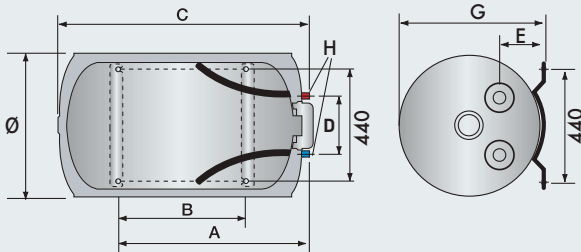
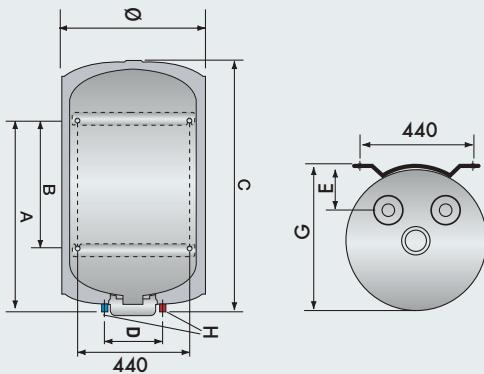

easy
and safe

**TECHNICAL DATA**

		ARI 150 V THER	ARI 150 H THER	ARI 200 V THER	ARI 200 H THER
Capacity	l	150	150	200	200
Power	kW	1,8	2	2,2	2
Voltage	V	230	230	230	230
Heating time (deltaT= 50°C)	h,min	5,10	4,40	5,35	5,50
Heat dispersion	kWh/24h	1,41	1,87	1,85	2,07
Max working temp.	°C	65	75	65	75
Protection	IP	IP25D	IP25	IP25D	IP25
Weight	kg	37	37	45	45

OVERALL DIMENSIONS

		ARI 150 V THER	ARI 150 H THER	ARI 200 V THER	ARI 200 H THER
a	mm	750	750	1050	1050
b	mm	500	500	800	800
c	mm	1010	1010	1270	1480
d	mm	230	230	230	230
e	mm	175	175	175	175
f	mm	560	560	560	510
g	mm	575	575	575	575
h	mm	G3/4	G3/4	G3/4	G3/4

CODE

3000326 3000365 3000327 3000366

LEGEND

- E** Cold water inlet G 3/4"
- U** Hot water outlet G 3/4"

ARI STAB



COMFORT

- Temperature regulation

EFFICIENCY&ENERGY SAVING

- Ecological polyurethane insulation

QUALITY

- Titanium glasslined inner tank tested at 16 bar
- Oversize magnesium anode
- 5-bolts flange
- Pressure safety valve tested at 8 bar

DESIGN

- Exclusive Italian design
- Floor Standing



floor standing

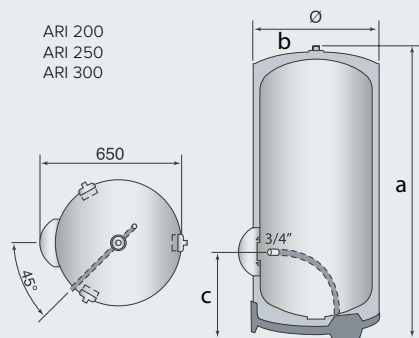

TECHNICAL DATA

		ARI 200 STAB	ARI 250 STAB	ARI 300 STAB	TI STI 500
Capacity	l	200	250	300	500
Power	kW	3,0	3,0	3,0	6,0
Voltage	V	230/400	230/400	230/400	230/400
Heating time (ΔT= 45°C)	h, min.	4,26	5,00	5,54	4,40
Max. Working Temp.	°C	75	75	75	75
Heat dispersion	kWh/24h	1,88	2,17	2,6	3,6
Max. Working Pressure	bar	8	8	8	8
Protection	IP	IP25D	IP25D	IP25D	IP25D
Weight	kg	50	61	71	95

OVERALL DIMENSIONS

		ARI 200 STAB	ARI 250 STAB	ARI 300 STAB	TI STI 500
a	mm	1320	1270	1800	1870
b	mm	560	560	560	710
c	mm	390	365	365	335

CODE

	ARI 200 STAB	ARI 250 STAB	ARI 300 STAB	TI STI 500
	3000363	3000351	3000328	3060373

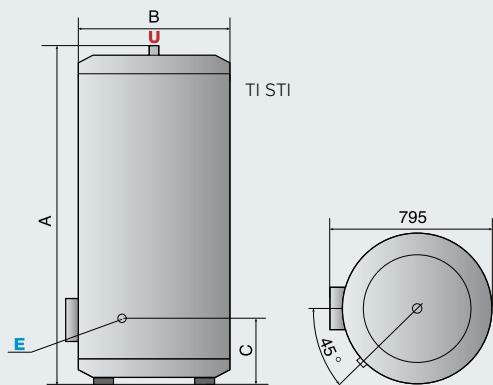

LEGEND
E Cold water inlet G 1"
U Hot water outlet G 1"



 **ARISTON**

ACCESSORIES

Accessories

Description	Code
<p>STAND for 100L to 200L</p> <ul style="list-style-type: none"> • ø 505 and 560 mm. Shift from diameter to another by turning over the stand • Rapid installation without tools. Consists of 2 rings and 4 tubes. Ring size 520mm • Height of the Ø505 water heater base from the ground = 521mm • Height of the Ø560 water heater base from the ground = 545mm • Can be equipped with stabilizer feet 	3018069
<p>LIFTING KIT FOR FLOOR STANDING MODELS</p> <p>Consists of four stainless steel feet and a belt to hold the top of the appliance against the wall (except 500l model). Plinth supplied pre-assembled on floor standing models. This feet lift installation by 17 cm</p>	3018044
<p>STABILISER FEET</p> <ul style="list-style-type: none"> • Supplied in sets of four. • Adapt to fit stand code 3018043 and the plinth of floor-standing model • Designed to compensate uneven floors 	3018050
<p>TRANSFER BRACKETS (150L and 200L)</p> <p>Can be used to make up the difference between the two fixing brackets when the appliance is replaced.</p> <ul style="list-style-type: none"> • Installation of 150L appliance with a 500mm center distance in place of an appliance with a center distance of 230, 320, 435, 550, 800 mm • Installation of 150L and 200L appliance with an 800mm center distance in place of an appliance with a center distance of 500, 540, 700 or 790 	3018051
<p>BELTS</p> <p>Ø505 and 560 mm for horizontal water heaters. Allows horizontal appliances to be installed on the floor or hung on the ceiling. Supplied in pairs.</p> <p>ø 505 ø 560</p>	396138 399004
<p>CEILING MOUNTING KIT</p> <p>To be used when the diving wall of a room can not support the weight of the appliance and as replacement for the universal tripod. Frees up space underneath the water heater</p> <p>100 lt 150 and 200 lt</p>	895930 3018073
<p>QUICK RECESSING KIT</p> <p>To be used when fixing a vertical recessed water heater in a place which is difficult to access (small cabinet or water heater recessed among 3 walls). Make sure that the two washer in the kit are 440 mm apart (bracket center distance). Fix the top bracket into these washers.</p>	1314450

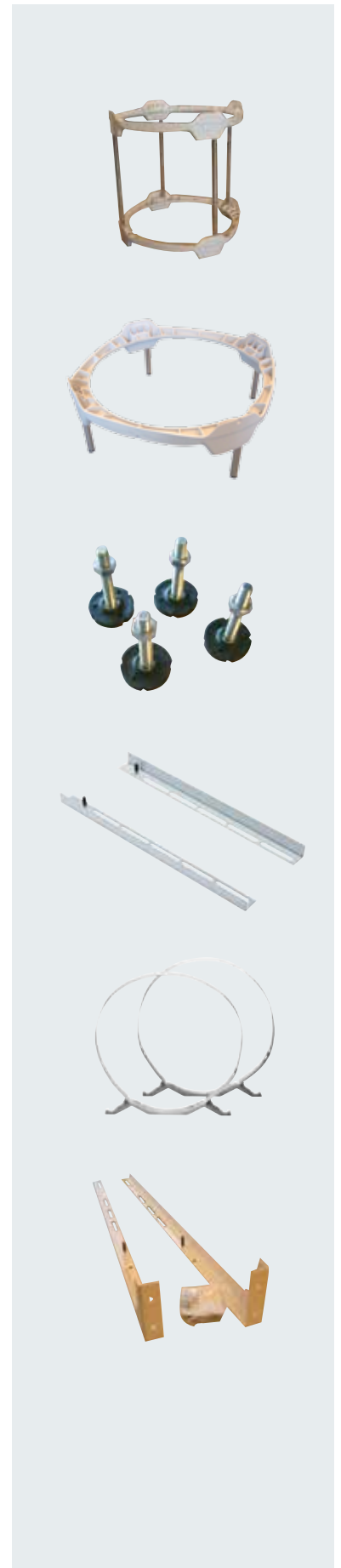

Accessories

Description	Code
<p>THERMOSTATIC MIXING VALVE Connection ¾", set to 50°C</p>	3018045
<p>DIELECTRIC CONNECTIONS The iron of the tank must be kept separate from the copper of the pipes to reduce the effect of corrosive currents. • Conforms to DTU601</p> <p>Kit 1 dielectric connection G3/4 Kit 2 dielectric connections G3/4</p>	3018071 935385
<p>OUTER INSULATING JACKET For 300L floor standing water heaters. Provides an extra layer of top protection for appliances located outside the dwelling</p>	343318
<p>ELECTRIC KIT (500 LITRES)</p> <p>9 kW 9000W complete with 1 thermostat – 1 immersed element on tray (with screw and cable) and 1 cap</p> <p>12 kW 12000W complete with 1 thermostat – 1 immersed element on tray (with screw and cable) and 1 cap</p>	935120 3018018
<p>ELECTRIC KIT (500 LITRES) 2.5 kW/Mono-phase Protech 1 fixed 2500W shielded element - 1 monophasé wired active anode 2 thermowells – 1 rod thermostat – 1 base unit gasket – 1 bag – 1 screw</p>	935334
<p>HYDRAULIC SAFETY GROUP ½"</p>	877084
<p>HYDRAULIC SAFETY GROUP ¾"</p>	877085
<p>SYPHON 1"</p>	877086

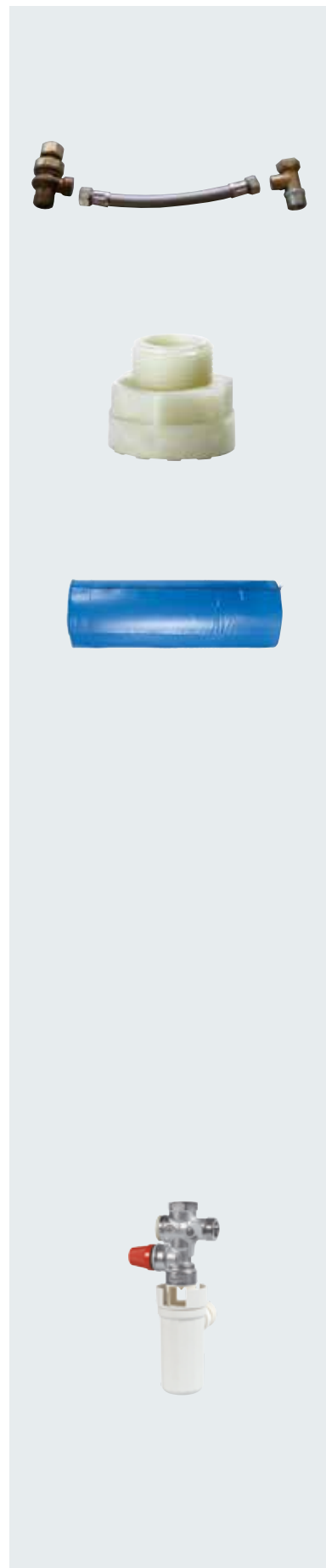

ES EXTRA THE NEW CALORIFIER RANGE BY ARISTON BROAD RANGE FOR ALL YOUR NEEDS



/ BROAD RANGE OF CAPACITY AND POWER

- From 500 to 5000 liters
- From 12 to 96 kW

/ AVAILABLE WITH EXTERNAL SOFT OR HARD JACKET

/ INTEGRATED CONTROL PANEL

ES EXTRA



EXTRA RESISTANT

- Max working pressure of 8 bar

LONG LASTING

- Oversized anti-rust magnesium anode + life-enhanced incoloy-800 heating elements with low surface charge

EASY TO OPERATE

- Plug-and-used solution with preinstalled components and inspection hand-hole flange (D. 110 mm)

HIGHLY EFFICIENT

- Double option insulation:
 - / Tank insulation with thickness 100 mm of soft polyurethane
 - / Tank insulation with thickness 100 mm of glass fiber wool and rigid external metal shell

SUPER SAFE

- ASME temperature and pressure relief valve supplied with the tank and functional and safety monophas thermostat

TECHNICAL DATA

Capacity	kW	Control Panel	Soft Jacket Code	Hard Jacket Code
500	12*	Basic	3080029	3080352
	24		3080081	3080353
750	12*	Basic	3080260	3080354
	24		3080273	3080355
	36		3080274	3080356
1000	18	Basic	3080333	3080357
	24		3080334	3080358
	36		3080335	3080359
1500	18	Basic	3080336	3080360
	24		3080337	3080361
	36		3080338	3080362
2000	24	Full	3080339	3080363
	36		3080340	3080364
	48		3080341	3080365
2500	36	Full	3080342	3080366
	48		3080343	3080367
	60		3080344	3080368
3000	48	Full	3080345	3080369
	60		3080346	3080370
	72		3080347	3080371
5000	48	Full	3080348	3080372
	60		3080349	3080373
	72		3080350	3080374
	96		3080351	3080375

* Without control panel

ES EXTRA

TECHNICAL DATA

Ariston ES Extra	Nominal Capacity (l)	Power (kW)	Heating Elements	Recovery time DT 40°C rise (min.)	Recovery time DT 45°C rise (min.)	Flow rate 40°C rise (l)	Flow rate 45°C rise (l)	First hour delivery 40°C rise (l)	First hour delivery 45°C rise (l)	Insulated tank heat losses (kWh/24h)	Soft jacket	Hard jacket
500 - 12	492	12	1	103	116	258	229	799	771	3,0	3080029	3080352
500 - 24	492	24	2	51	58	516	459	1057	1000	3,0	3080081	3080353
750 - 12	760	12	1	159	179	258	229	1094	1065	5,6	3080260	3080354
750 - 24	760	24	2	80	89	516	459	1352	1295	5,6	3080273	3080355
750 - 36	760	36	3	53	60	774	688	1610	1524	5,6	3080274	3080356
1000 - 18	947	18	2	132	149	387	344	1429	1386	6,0	3080333	3080357
1000 - 24	947	24	2	99	111	516	459	1558	1500	6,0	3080334	3080358
1000 - 36	947	36	3	66	74	774	688	1816	1730	6,0	3080335	3080359
1500 - 18	1490	18	2	208	234	387	344	2026	1983	8,3	3080336	3080360
1500 - 24	1490	24	2	156	175	516	459	2155	2098	8,3	3080337	3080361
1500 - 36	1490	36	3	104	117	774	688	2413	2327	8,3	3080338	3080362
2000 - 24	2001	24	2	209	236	516	459	2717	2660	8,9	3080339	3080363
2000 - 36	2001	36	3	140	157	774	688	2975	2889	8,9	3080340	3080364
2000 - 48	2001	48	4	105	118	1032	917	3233	3118	8,9	3080341	3080365
2500 - 36	2505	36	3	175	197	774	688	3530	3444	10,0	3080342	3080366
2500 - 48	2505	48	4	131	147	1032	917	3788	3673	10,0	3080343	3080367
2500 - 60	2505	60	5	105	118	1290	1147	4046	3902	10,0	3080344	3080368
3000 - 48	2845	48	4	149	167	1032	917	4162	4047	11,4	3080345	3080369
3000 - 60	2845	60	5	119	134	1290	1147	4420	4276	11,4	3080346	3080370
3000 - 72	2845	72	5	99	112	1548	1376	4678	4506	11,4	3080347	3080371

CALORIFIERS - DIMENSIONS AND TECHNICAL DATA

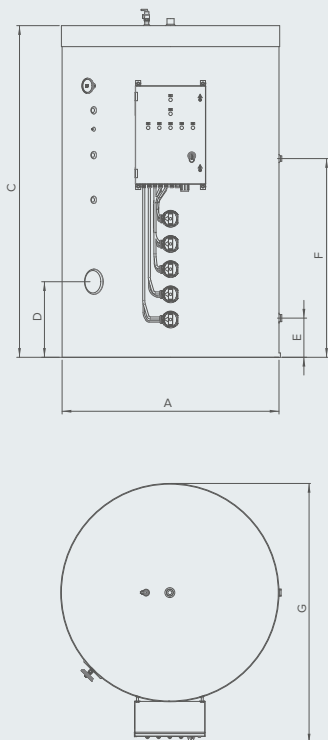

Model		ES EXTRA 500	ES EXTRA 750	ES EXTRA 1000	ES EXTRA 1500	ES EXTRA 2000	ES EXTRA 2500	ES EXTRA 3000
Capacity	l	492	760	942	1490	2001	2505	2845
Max working pressure	bar	8	8	8	8	8	8	8
A	mm	850	990	990	1200	1400	1450	1550
Tank diameter	mm	650	790	790	1000	1200	1250	1350
C	mm	1905	1945	2345	2335	2245	2410*	2420*
D	mm	530	575	560	595	705	615	540
E water inlet	mm	250	290	290	365	435	345	270
F recirculation	mm	1070	1030	1210	1275	1205	1250	1410
G	mm	1000	1140	1140	1350	1700	1750	1850
Empty weight	kg	110	170	190	310	381	461	506
Max number of heating element	Nr.	2	3	3	3	4	5	5
Cold water inlet		R 2" GM	R 2" GM	R 2" GM	R 2" GM	R 2" GM	R 2" GM	R 2" GM
Hot water outlet		R 2" M	R 2" M	R 2" M	R 2" M	R 2" M	R 2" M	R 2" M
Recirculation		R 1 1/2 GM	R 1 1/2 GM	R 1 1/2 GM	R 1 1/2 GM	R 1 1/2 GM	R 1 1/2 GM	R 1 1/2 GM
Drain		Rp 1 1/4 G	Rp 1 1/4 G	Rp 1 1/4 G	Rp 1 1/4 G	Rp 1 1/4 G	Rp 1 1/4 G	Rp 1 1/4 G
Probe connection		Rp 3/8" G	Rp 3/8" G	Rp 3/8" G	Rp 3/8" G	Rp 3/8" G	Rp 3/8" G	Rp 3/8" G

* with feet installed

ES EXTRA

CONTROL PANEL VERSION BASIC

500 to 1500 lt



Electric Control Panel basic to manage the calorifiers with 2 to 3 heating elements powered with triphase thermostat inside the box,

Features:

- / Metal box finished in durable paint and water resistant grade IP 65 with front cover fixed with 4 secure screws.
- / Terminal block connections to achieve easy and safe wiring of the main three phase line 380V - 400V - 415V.
- / Fuse block with cartridge type fuses designed to interrupt the supply lines.

CONTROL PANEL VERSION FULL

(up to 60 kW)

2000 to 3000 lt



Electric Control Panel full for installed powers from 24 to 60 kw with the following features:

- / Metal box finished in durable paint and water resistant grade IP 65.
- / Terminal block connections for easy and safe wiring of the main three phase line 380V - 400V - 415V.
- / Fuse block with cartridge type fuses designed to interrupt the supply lines.
- / Magnetic contactors (power relay) to control the safety request coming from no water presence in the tank. The functionality and the safety of the heating elements are directly controlled by the triphase thermostat installed on each element of 12 kW powered.
- / Double insulated transformer to manage the voltage 400V to 230V for the lamps and switch devices.
- / Electronic circuit and double insulation immersed detector to have the low water cut off device operating on the safety magnetic contactors to cut the main three phase line and stop the heating elements.
- / BMS - Building Management System: free contact relays are factory installed to remote the signals.
- / Door interlocked by main isolator switch.
- / White light lamp to signal the main line presence.
- / Orange light lamps to signal the safety alarm due to no water in the tank and stop of the heating.
- / Green light lamps to signal the functionality run of each heating elements.

ES EXTRA 5000



EXTRA RESISTANT

- Max working pressure of 8 bar

LONG LASTING

- Oversized anti-rust magnesium anode + life-enhanced incoloy-800 heating elements with low surface charge

EASY TO OPERATE

- Plug-and-use solution with preinstalled components and inspection man-hole flange (D. 400 mm)

HIGHLY EFFICIENT

- 80 mm tank insulation with injected polyurethane foam C.F.C. - free density 45 kg/mc and external skin in different materials and grade of fire resistant: B3, B1 and A2 according DIN 4102

SUPER SAFE

- ASME temperature and pressure relief valve supplied with the tank + monophasic thermostat (functional and safety) with bulb immersed CE homologated

TECHNICAL DATA

Ariston ES Extra	Nominal Capacity (l)	Power (kW)	Heating Elements	Recovery time DT 40°C rise (min.)	Recovery time DT 45°C rise (min.)	Flow rate 40°C rise (l)	Flow rate 45°C rise (l)	First hour delivery 40°C rise (l)	First hour delivery 45°C rise (l)	Insulated tank heat losses (kWh/24h)	Soft jacket	Hard jacket
5000 - 48	4901	48	4	256	289	1032	917	6423	6308	8,0	3080348	3080372
5000 - 60	4901	72	5	205	231	1290	1147	6681	6538	8,0	3080349	3080373
5000 - 72	4901	72	5	171	192	1548	1376	6939	6767	8,0	3080350	3080374
5000 - 96	4901	96	6	128	144	2064	1835	7455	7226	8,0	3080351	3080375

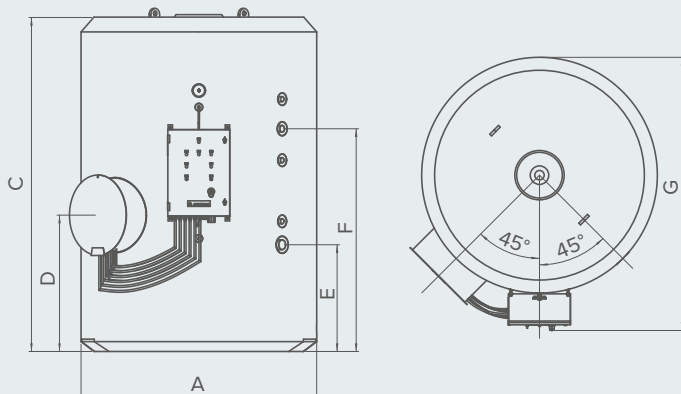

Model	5000	
Max working pressure	bar	8
A external diameter	mm	1910
Tank diameter	mm	1750
C overall height	mm	2750
D water inlet pipe	mm	865
E water recirculation pipe	mm	1805
F inspection flange	mm	1105
G depth	mm	2210
Empty weight	kg	1030
Cold water inlet		R 3" M
Hot water outlet		R 3" M
Recirculation		R 2" M
Drain		R 1 1/2" M
Probe connection		R 3/4" M

ARISTON OFFERS COMPLETE CUSTOMER SATISFACTION

The Internet site provides operators within the sector with all the information which are linked to the “product catalogue”, offering individual details of technical features, exploded views and spare parts lists, updates for operating booklets and instruction manuals. It provides users with telephone numbers and addresses for the relevant Assistance Centres and stockists in their local area.

ariston.com



SERVICE

The capillary network of Ariston Technical Assistance Centres has been developed to cover the entire country, in order to guarantee emergency and routine maintenance operations which demonstrate efficiency and a high degree of professional preparation.

A group of experts also support our Customers in the constant updating process relating to new products and technologies





ARISTON THERMO GROUP

Ariston Thermo SpA
Viale A. Merloni, 45 • 60044 Fabriano (AN) - ITALY
Fax: 0732 602416

ariston.com

Ariston Thermo SpA Middle East Branch
Dubai Airport Freezone
Office No. 5EA 414 • P.O. Box 54643 Dubai - UAE
Fax +971 4 2364839

info.me@aristonthermo.com